

## Brass Water Flow Indicator

<b>Product Type</b>	:SG-YL11-03
<b>Product Sizes</b>	:DN6 to DN25(1/8" Inch to 1" Inch)
<b>Material of Construction</b>	
<b>Body&amp;Cap</b>	:SS304 / SS316 / SS316L or Brass
<b>Sealing Gasket</b>	:PTFE(White)/NBR(Black)/Viton(Black)
<b>Sight Glass</b>	:Tempered Glass
<b>Impeller/Rotor</b>	:Plastic(Red)/PTFE(Red)
<b>Connection Way</b>	:NPT,BSPP,BSPT Female Thread
<b>Max. Working Temperature</b>	:100°C / 212°F for Plastic Impeller&NBR or NBR Gasket 200°C / 392°F for PTFE Impeller&Gasket
<b>Max. Operating Pressure</b>	:0.6MPa / 6Bar / 87PSI
<b>Compatible Medium</b>	:Water / Oil / Gas / Air / Liquids



Wenzhou Luosimeng Machinery Co.Ltd.



Wenzhou Luosimeng Machinery Co.Ltd.



Wenzhou Luosimeng Machinery Co.Ltd.

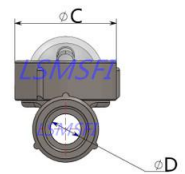
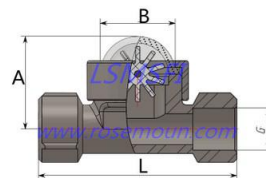

1/4" Inch	L:70mm	A:55mm	B:38mm	C:53mm	D:11mm	0.38Kg/Pce
3/8" Inch	L:70mm	A:55mm	B:38mm	C:53mm	D:14mm	0.37Kg/Pce
1/2" Inch	L:77mm	A:60mm	B:39mm	C:53mm	D:19mm	0.44Kg/Pce
3/4" Inch	L:79mm	A:60mm	B:39mm	C:53mm	D:24mm	0.49Kg/Pce
1" Inch	L:79mm	A:60mm	B:39mm	C:53mm	D:30mm	0.52Kg/Pce



## Wenzhou Luosimeng Machinery Co.,Ltd. (Sight Flow Indicator Manufacturer)