

Sight Glass Flow Indicator

- Product Type** :SG-YL11-1
- Product Sizes** :DN6 to DN25(1/8”Inch to 1”Inch)
- Material of Construction**
 - Body&Cap** :SS304 / SS316 / SS316L or Carbon Steel(WCB)
 - Sealing Gasket** :PTFE(White)/NBR(Black)/Viton(Black)
 - Sight Glass** :Tempered/Borosilicate/Quartz/Aluminosilicate Glass
 - Impeller/Rotor** :Plastic (Red) or PTFE (Red or Blue)
- Connection Way** :NPT,BSPP,BSPT Female Thread
- Max. Working Temperature** :100°C / 212°F for Plastic Impeller&NBR or Viton Gasket
200°C / 392°F for PTFE Impeller&Gasket
- Max. Operating Pressure** :1.6MPa / 16Bar / 232PSI (Up to 5.0MPa Customization)
- Compatible Medium** :Water / Oil / Gas / Air / Liquids



Wenzhou Luosimeng Machinery Co.Ltd.



Wenzhou Luosimeng Machinery Co.Ltd.



Wenzhou Luosimeng Machinery Co.Ltd.

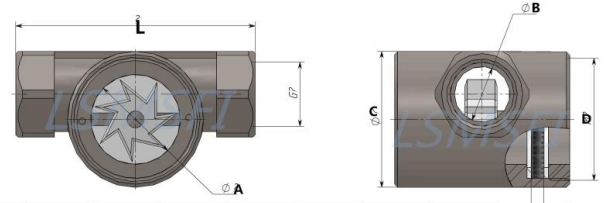

G 1/8	L: 84mm	A: 35mm	B: 8mm	C: 52mm	D: 47mm	E: 8mm	F: 62mm	0.57Kg
G 1/4	L: 84mm	A: 35mm	B: 12mm	C: 52mm	D: 47mm	E: 8mm	F: 62mm	0.56Kg
G 3/8	L: 84mm	A: 35mm	B: 15mm	C: 52mm	D: 47mm	E: 8mm	F: 62mm	0.54Kg
G 1/2	L: 88mm	A: 35mm	B: 19mm	C: 52mm	D: 47mm	E: 8mm	F: 62mm	0.65Kg
G 3/4	L: 98mm	A: 35mm	B: 24mm	C: 52mm	D: 47mm	E: 8mm	F: 62mm	0.63Kg
G 1	L: 98mm	A: 35mm	B: 30mm	C: 52mm	D: 47mm	E: 8mm	F: 64mm	0.70Kg
G 1 1/4	L: 110mm	A: 35mm	B: 39mm	C: 52mm	D: 47mm	E: 8mm	F: 71mm	1.05Kg
G 1 1/2	L: 119mm	A: 44mm	B: 45mm	C: 63mm	D: 55mm	E: 8mm	F: 81mm	1.39Kg
G 2	L: 134mm	A: 55mm	B: 57mm	C: 73mm	D: 62mm	E: 8mm	F: 92mm	1.97Kg



Wenzhou Luosimeng Machinery Co.,Ltd. (Sight Flow Indicator Manufacturer)