

Impeller Sight Flow Indicator

| | |
|---------------------------------|--|
| Product Type | :SG-YL11-1 |
| Product Sizes | :DN32 to DN50(1 1/4”Inch to 2”Inch) |
| Material of Construction | |
| Body&Cap | :SS304 / SS316 / SS316L or Carbon Steel(WCB) |
| Sealing Gasket | :PTFE(White)/NBR(Black)/Viton(Black) |
| Sight Glass | :Tempered/Borosilicate/Quartz/Aluminosilicate Glass |
| Impeller/Rotor | :Plastic (Red) or PTFE (Red or Blue) |
| Connection Way | :NPT,BSPP,BSPT Female Thread |
| Max. Working Temperature | :100°C / 212°F for Plastic Impeller&NBR/Viton Gasket 200°C / 392°F for PTFE Impeller&Gasket |
| Max. Operating Pressure | :1.6MPa / 16Bar / 232PSI (Up to 5.0MPa Customization) |
| Compatible Medium | :Water / Oil / Gas / Air / Liquids |

LSMSFI



Wenzhou Luosimeng Machinery Co.Ltd.

LSMSFI



Wenzhou Luosimeng Machinery Co.Ltd.

LSMSFI



Wenzhou Luosimeng Machinery Co.Ltd.

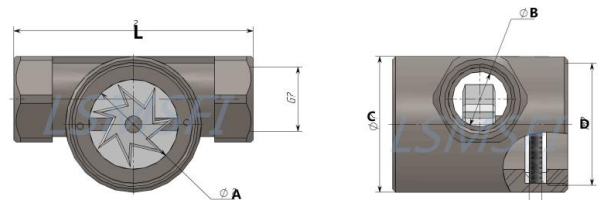

| | | | | | | | | |
|---------|----------|---------|---------|---------|---------|--------|---------|--------|
| C 1/8 | L: 84mm | A: 35mm | B: 8mm | C: 52mm | D: 47mm | E: 8mm | F: 62mm | 0.57Kg |
| C 1/4 | L: 84mm | A: 35mm | B: 12mm | C: 52mm | D: 47mm | E: 8mm | F: 62mm | 0.56Kg |
| C 3/8 | L: 84mm | A: 35mm | B: 15mm | C: 52mm | D: 47mm | E: 8mm | F: 62mm | 0.54Kg |
| C 1/2 | L: 88mm | A: 35mm | B: 19mm | C: 52mm | D: 47mm | E: 8mm | F: 62mm | 0.65Kg |
| C 3/4 | L: 98mm | A: 35mm | B: 24mm | C: 52mm | D: 47mm | E: 8mm | F: 62mm | 0.63Kg |
| C 1 | L: 98mm | A: 35mm | B: 30mm | C: 52mm | D: 47mm | E: 8mm | F: 64mm | 0.70Kg |
| C 1 1/4 | L: 110mm | A: 35mm | B: 39mm | C: 52mm | D: 47mm | E: 8mm | F: 71mm | 1.05Kg |
| C 1 1/2 | L: 119mm | A: 44mm | B: 45mm | C: 63mm | D: 55mm | E: 8mm | F: 81mm | 1.39Kg |
| C 2 | L: 134mm | A: 55mm | B: 57mm | C: 73mm | D: 62mm | E: 8mm | F: 92mm | 1.97Kg |

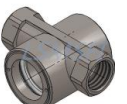

Wenzhou Luosimeng Machinery Co.,Ltd.
(Sight Flow Indicator Manufacturer)