

## Metal Rotor Flow Indicator

|                                 |   |
|---------------------------------|---|
| <b>Product Type</b>             | :SG-YL11-3  |
| <b>Product Sizes</b>            | :DN6 to DN50(1/8”Inch to 2”Inch)  |
| <b>Material of Construction</b> |   |
| <b>Body&amp;Cap</b>             | :SS304 / SS316 / SS316L or Carbon Steel(WCB)  |
| <b>Sealing Gasket</b>           | :PTFE(White)/NBR(Black)/Viton(Black)  |
| <b>Sight Glass</b>              | :Tempered/Borosilicate/Quartz/Aluminosilicate Glass   |
| <b>Impeller/Rotor</b>           | :Metal(Silver/Blue)   |
| <b>Connection Way</b>           | :NPT,BSPP,BSPT Female Thread  |
| <b>Max. Working Temperature</b> | :100°C / 212°F for Plastic Impeller&NBR or Viton Gasket<br>200°C / 392°F for PTFE Impeller&Gasket |
| <b>Max. Operating Pressure</b>  | :1.6MPa / 16Bar / 232PSI (Up to 5.0MPa Customization)   |
| <b>Compatible Medium</b>        | :Water / Oil / Gas / Air / Liquids  |



Wenzhou Luosimeng Machinery Co.Ltd.



Wenzhou Luosimeng Machinery Co.Ltd.



Wenzhou Luosimeng Machinery Co.Ltd.

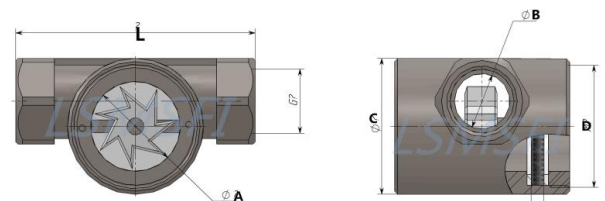

|         |          |         |         |         |         |        |         |        |
|---------|----------|---------|---------|---------|---------|--------|---------|--------|
| C 1/8   | L: 84mm  | A: 35mm | B: 8mm  | C: 52mm | D: 47mm | E: 8mm | F: 62mm | 0.57Kg |
| C 1/4   | L: 84mm  | A: 35mm | B: 12mm | C: 52mm | D: 47mm | E: 8mm | F: 62mm | 0.56Kg |
| C 3/8   | L: 84mm  | A: 35mm | B: 15mm | C: 52mm | D: 47mm | E: 8mm | F: 62mm | 0.54Kg |
| C 1/2   | L: 88mm  | A: 35mm | B: 19mm | C: 52mm | D: 47mm | E: 8mm | F: 62mm | 0.65Kg |
| C 3/4   | L: 98mm  | A: 35mm | B: 24mm | C: 52mm | D: 47mm | E: 8mm | F: 62mm | 0.63Kg |
| C 1     | L: 98mm  | A: 35mm | B: 30mm | C: 52mm | D: 47mm | E: 8mm | F: 64mm | 0.70Kg |
| C 1 1/4 | L: 110mm | A: 35mm | B: 39mm | C: 52mm | D: 47mm | E: 8mm | F: 71mm | 1.05Kg |
| C 1 1/2 | L: 119mm | A: 44mm | B: 45mm | C: 63mm | D: 55mm | E: 8mm | F: 81mm | 1.39Kg |
| C 2     | L: 134mm | A: 55mm | B: 57mm | C: 73mm | D: 62mm | E: 8mm | F: 92mm | 1.97Kg |

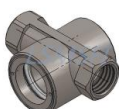

**Wenzhou Luosimeng Machinery Co.,Ltd.**  
(Sight Flow Indicator Manufacturer)